



GDS Belt Drive

Models GDS 450 Belt, GDS 630 Belt, GDS 230 LVL Belt, GDS 450 LVL Belt

GDS - Your Automatic Choice

GENERAL INFORMATION

- Belt drive systems are unique to GDS Australia.
- Belt drive systems combine the features of rack and chain drive systems while doing away with the disadvantages of rack and chain drive systems!
- Belt drive systems provide constant drive of the gate, despite the condition of either the track or gate, while at the same time never having the need to lubricate, as is required with the chain drive systems.

TECHNICAL DETAILS

MODEL	GDS 450 Belt	GDS 630 Belt	GDS 230 LVL Belt	GDS 450 LVL Belt
Motor Power	550 W	750 W	24V 120 W	24V 120 W
Gate Speed (approx)	450mm/sec Variable speed	630mm/sec Variable Speed	230mm/sec Variable Speed	450mm/sec VariableSpeed
Input Power	240V 10A	240V 10A	240V - 24V	240V - 24V

SPECIFICATIONS

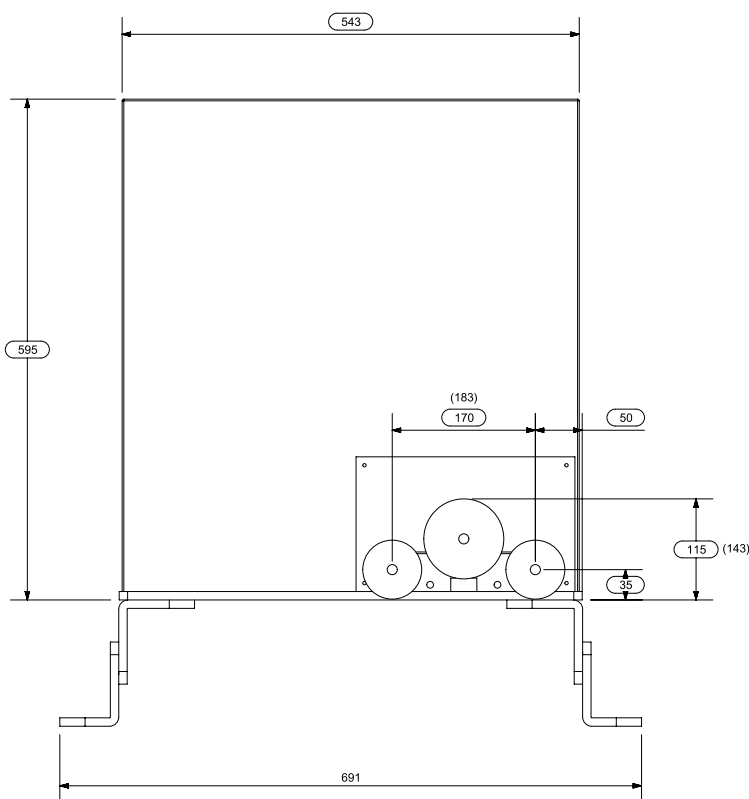

Numbers in Brackets are for the GDS 630 Belt plate variations

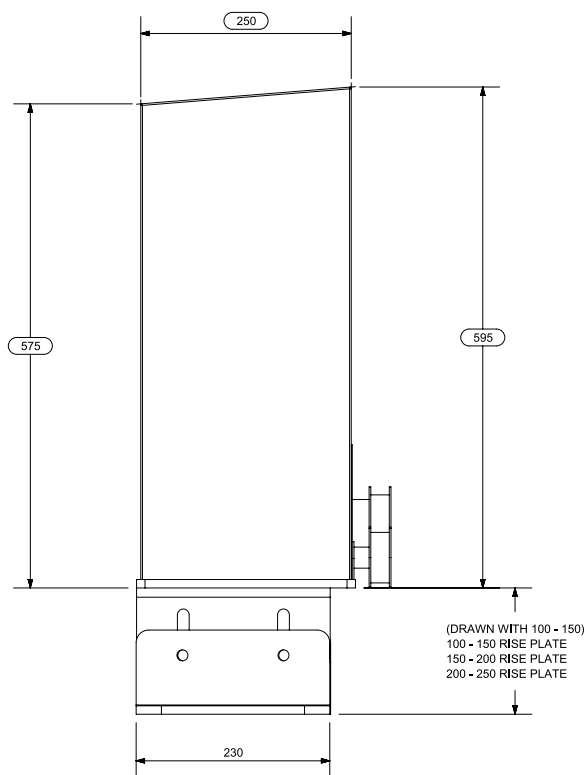

BELT NOT INCLUDED WITH OPERATOR - QUANTITY REQUIRED DEPENDS ON LENGTH OF GATE: PLEASE ORDER BELT SEPARATELY

Note: All automation applications require external photo electric cell protection/induction loop and appropriate warning signs and/or devices.

Manufactured by:



N14870